

# GEMAS ABS INLETS FOR CONCRETE POOLS

## TECHNICAL DATA SHEET



*"Pool Technology"*

### Wall Inlets:

Injected of white ABS plastic with adjustable ball for alternative discharges.



Ø 14 mm ball 3 m<sup>3</sup>/h  
 Ø 20 mm ball 5 m<sup>3</sup>/h  
 Ø 25 mm ball 7 m<sup>3</sup>/h

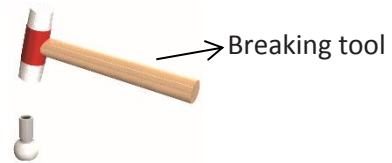

### Dimensions:

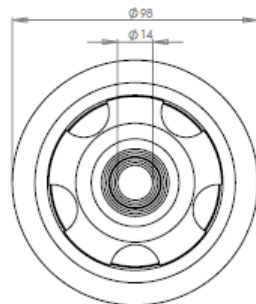
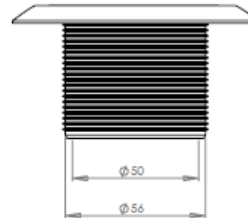
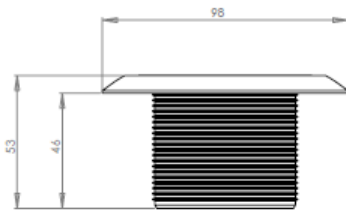

DESCRIPTION	CODE	PIECES/BOX	WEIGHT (kg)	VOLUME (m <sup>3</sup> )
Wall Inlet for Concrete Pools. 2" Male threaded : Ø 50 mm internal slip connection.	04131T	10	1.00	0.006
Wall Inlet for Concrete Pools Unthreaded : 2" Slip to be glued inside Ø 63 mm (10 atm) pipe.	04131S	10	1.00	0.006
Breaking Tool	04131T05			

### Wall Inlets:

According to EU 13451-1/4.8.3 Injected of white ABS plastic with protection and adjustable ball for alternative discharges.



Ø 14 mm ball 3 m<sup>3</sup>/h  
 Ø 20 mm ball 5 m<sup>3</sup>/h  
 Ø 25 mm ball 7 m<sup>3</sup>/h

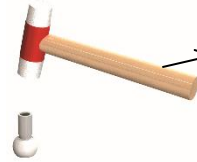

Breaking tool

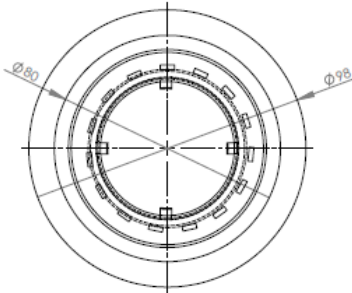
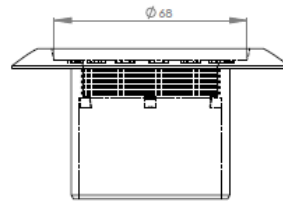
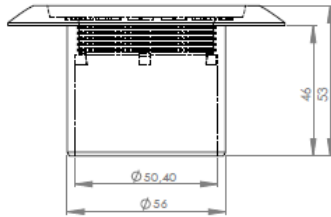

DESCRIPTION	CODE	PIECES/BOX	WEIGHT (kg)	VOLUME (m <sup>3</sup> )
Wall Inlet for Concrete Pools. 2" Male threaded : Ø 50 mm internal slip connection.	04131TP	10	1.10	0.006
Wall Inlet for Concrete Pools Unthreaded : 2" Slip to be glued inside Ø 63 mm (10 atm) pipe.	04131SP	10	1.06	0.006



"Pool Technology"

**04134T Suction Inlets:**



Injected of white ABS plastic with automatic air purge.

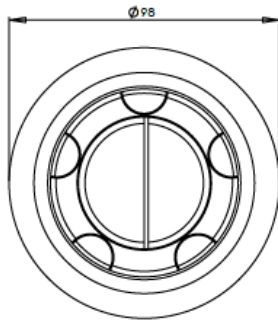
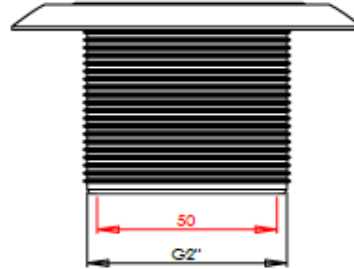
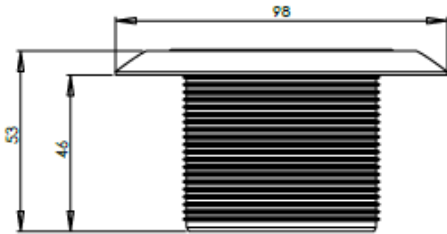

**04134S Suction Inlets:**

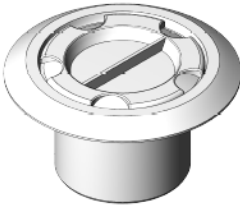

Injected of white ABS plastic with automatic air purge.

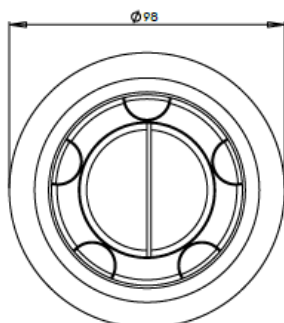
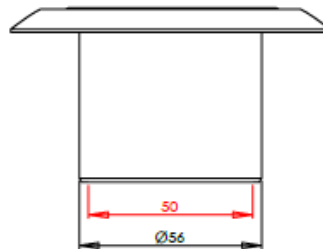
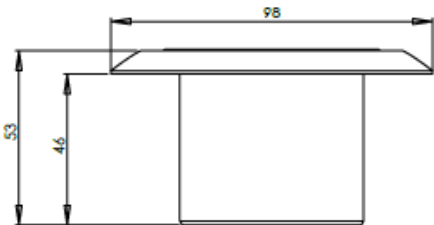

DESCRIPTION	CODE	PIECES/BOX	WEIGHT (kg)	VOLUME (m <sup>3</sup> )
Wall Inlet for Concrete Pools. 2" Male threaded : Ø 50 mm internal slip connection.	04134T	10	0.90	0.006
Wall Inlet for Concrete Pools Unthreaded : 2" Slip to be glued inside Ø 63 mm (10 atm) pipe.	04134S	10	0.90	0.006

